



250 SERIES

- Correlation to:
ASTM D1657
ASTM D1250
- Calculation of Propane/Butane
percentage



**Portable/Laboratory Density Meter
For Liquefied Petroleum Gases (LPG)**

DM-250.3 (LPG Di)

IN PROCESS TO EXCELLENCE

Principle of Operation

Density and Viscosity

For Density and Viscosity measurements a vibrating sensor is used. The sensor consists of a compact cylindrical tube that is vibrated in a hoop mode which delivers a balanced drive. This unique quality of the sensor allows for it to be installed not only with a rigid mounting, but also suspended on cables or using tape measures.

Density is determined using the well established resonant frequency principle. By alternately driving the sensor into vibration at the upper and lower half power (3dB) frequencies the bandwidth can be determined, which is also a function of the dynamic viscosity of the fluid.

Thus a single sensor will report the density, dynamic viscosity and temperature (from an integral RTD sensor) and thus kinematic viscosity can also be determined.

By using calculations based on the ASTM D341 equations, the kinematic viscosity can be calculated at a reference temperature. Base density can be calculated based on the methods defined in the Manual of Petroleum Measurement Standards.

DM-250.3 (LPG Di) Overview

OLED display

Device controller with
Built-in Bluetooth

Probe safety body

Manometer

Temperature
sensor
Density
sensor

Measuring chamber
housing

Outlet valve

Inlet valve

Measuring chamber

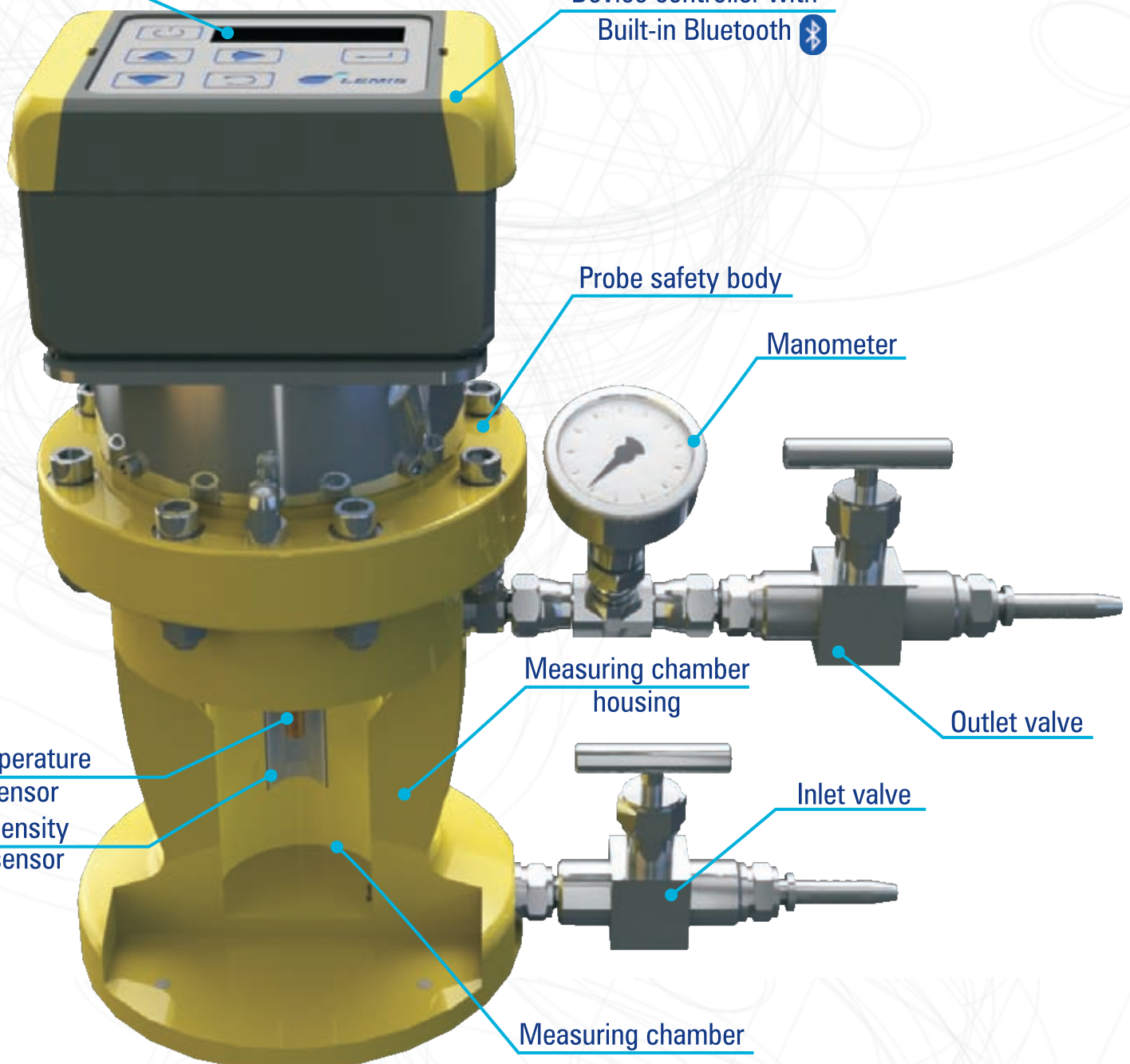

Dimensions

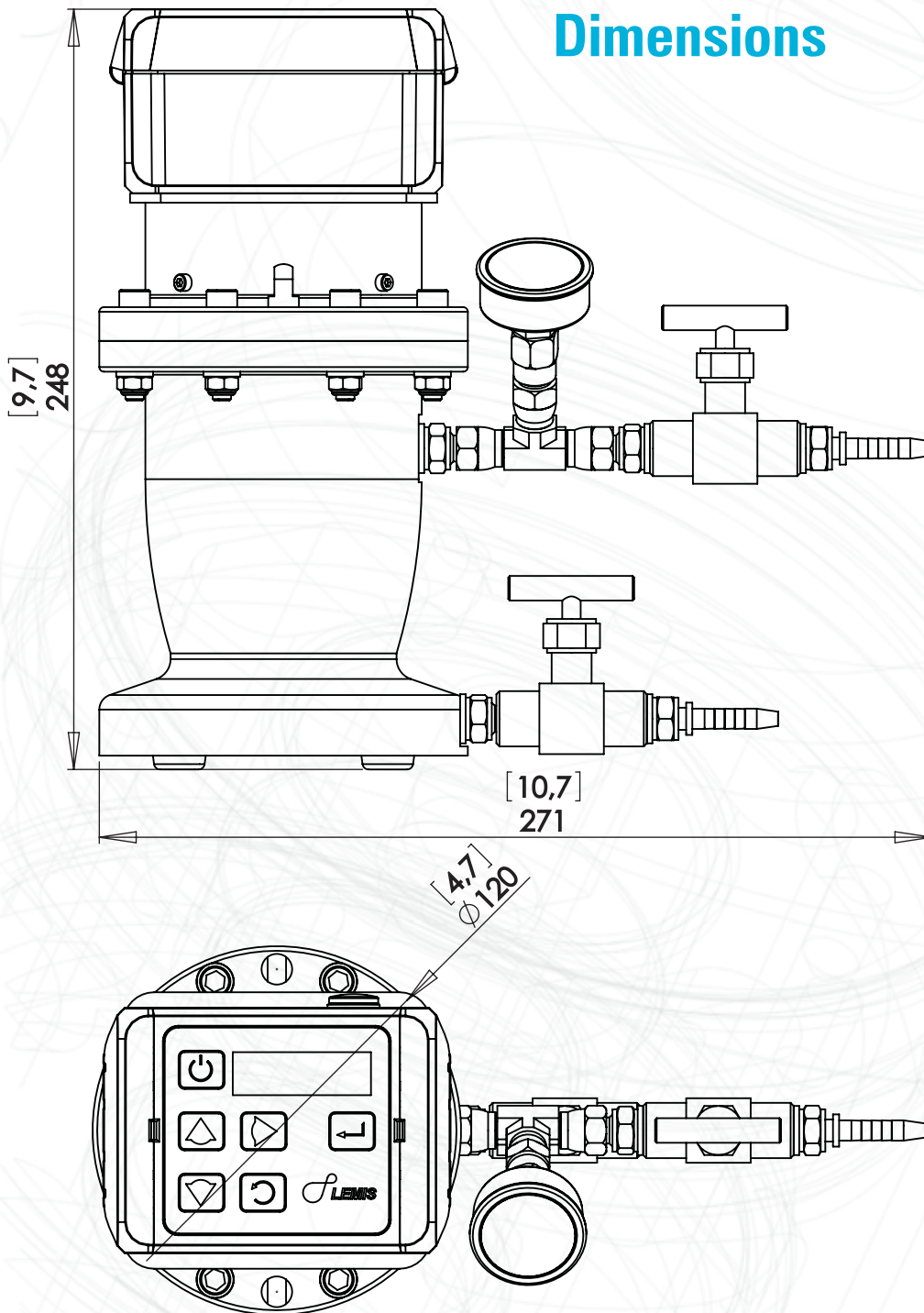

Advantages

- Direct density measurement
- Rigorous factory calibration and testing
- Automatic temperature compensation
- Small and compact
- Maintenance free
- Excellent correlation to ASTM D1657
- Readings on OLED Display
- Easy to operate
- Data transfer to PC

Applications

- LPG filling stations
- LPG fiscal transfer
- LPG storage
- Petroleum industry
- Concentration control at outlets and delivery points

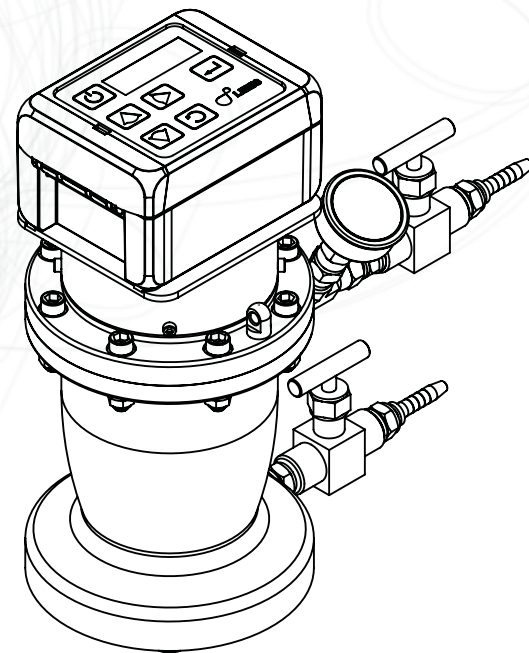

Easy Measurement Visualization

Date and Time of measurement

14/Oct/17
17:00

Referred Density

D15: 0.5086 g/cm³
D20: 0.5011 g/cm³

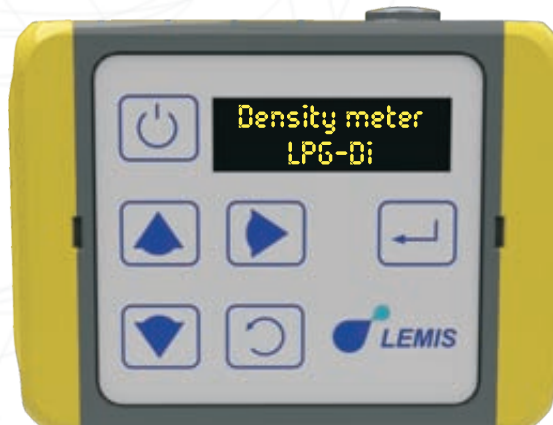

Density and Temperature

T: 25.69 °C
D 0.4659 g/cm³

Tank Nr. and Propan/Butane percentage

Tank Nr: 100
%Pr/Bu: 100/0%

Specifications

Measuring range:

Density	0... 3 g/cm ³ (0... 3000 kg/m ³)
Density Standard calibration	0.475... 1.0 g/cm ³ (475... 1000 kg/m ³)
Temperature	-40... +85°C (-40... +185°F)

Accuracy:

Density	±0.0003 or ±0.0005 g/cm ³ (±0.3 or ±0.5 kg/m ³)
Temperature	±0.1°C (±0.2°F) or ±0.2°C (±0.4°F)

Repeatability:

Density	±0.00015 or ±0.00025 g/cm ³ (±0.15 or ±0.25 kg/m ³)
Temperature	±0.1°C (±0.2°F)

Resolution:

Density	0.0001 g/cm ³ (0.1 kg/m ³)
Temperature	0.01°C (0.02°F)

Supported measuring units

Real Density: g/cm³, kg/m³, lb/gal, lb/ft³; API; SG
 Referred Density: at 15°C, 20°C, 60°F; API60; SG60
 Tables ASTM D 1250
 Temperature in °C or °F

Ambient temperature

-40... +50°C (-40... +122°F)

Maximum Pressure

16 bar (1.6 MPa)

Testing Pressure

25 bar (2.5 MPa)

Sensor:

Type	Vibrating element (Resonance principle)
Material	Stainless steel SS 316 L; NiSpan C; Hastelloy C22; Teflon

Hazardous environment Approvals

Controller	II 2G (1G) Ex ib [ia Ga] IIB T4 Gb
Sensor	II 1G Ex ia IIB T4 Ga

Power supply

NiMH 3.6V-2500 mAh

Charging device

Input: AC 100-240 V AC; Output: 4,5 – 9,5 V DC
 Charge: 0.8 A

Operating time without charging

up to 24 hours

Continuous operating time

No less than 10 hours

Dimensions, weight:

Density Meter	247 x 271 x 120 mm (9.7 x 10.6 x 4.72 in) 5.5 kg (12.1 lb)
---------------	--

Connections

Adapter ø6mm; other connections is customized

Temperature compensation

Automatic

Sample volume

250 ml

Data handling

OLED Display (2x12) with backlight
 Local memory up to 2000 results with date/time stamped
 Build in Bluetooth or USB for data transfer to printer or PC
 Optional Windows - based software

Delivery

Delivered in compact carrying case

* optional

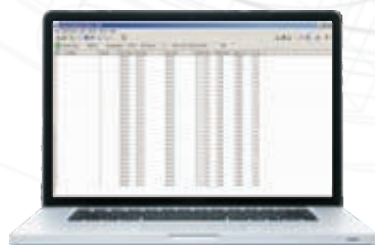

Multifunctional software
 compatible for Windows 7/8/10



Immediate printout of the
 measurements by Bluetooth
 No need for PC*



Delivered in compact carrying case

For more information please visit www.lemis-usa.com



LEMIS USA, Inc

15556 Summit Park Dr., Suite 601

Montgomery

TX 77356, USA

Ph.: +1 281 465 8441

E-mail: info@lemis-usa.com

